



C50



TECHNICAL DATA

PRELIMINARY PRICELIST

C50

LOA	15,39 m	50'6"
Hull length	14,99 m	49'3"
LWL	14,75 m	48'5"
Beam max.	5,05m	16'7"
Standard draft	2,30 m	7'7"
Shallow draft	1,85 m	6'1"
Deep draft	2,70 m	8'10"
Ballast	4.500 / 4.500 / 4.020 kg	9.920 / 9.920 / 8.862 lbs
Displacement	15.490 kg	26.312 lbs
Engine std	58,8 kW / 80 hp	58,8 kW / 80 hp
Fuel tank [approx.]	250 L	66 gal
Water tank [approx.]	650 L	143 gal
Sail area	135 / 147 m ²	1.453 / 1.582 sq ft
Mainsail std	76 / 83 m ²	818 / 893 sq ft
Mainsail furling	73 m ²	785 sq ft
Genoa	59 / 64 m ²	635 / 688 sq ft
Gennaker	195 / 215 m ²	2.098 / 2.314 sq ft
Code 0	115 / 121 m ²	1.237 / 1.302 sq ft
Mast height above WL	23,25 / 23,73 m	76'4" / 77'10" ft
I	20,00 / 20,42 m	65'6" / 67' ft
J	5,77 / 6,12 m	18' / 20'1" ft
P	19,15 / 20,00 m	62'10" / 66'6" ft
E	6,66 / 7,00 m	21'10" / 23' ft
CE category	A	A
Design	Cossutti Yacht Design	Cossutti Yacht Design

TRIM LEVEL	BASE PRICE EX WORKS EXCL. VAT
Trim Level Holiday	274.900 €
Trim Level Style	288.900 €
Trim Level Ambition	295.900 €

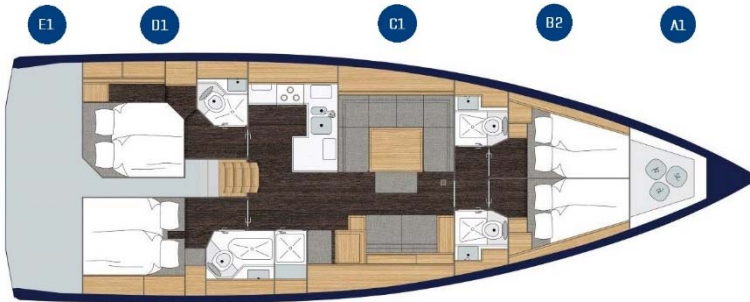
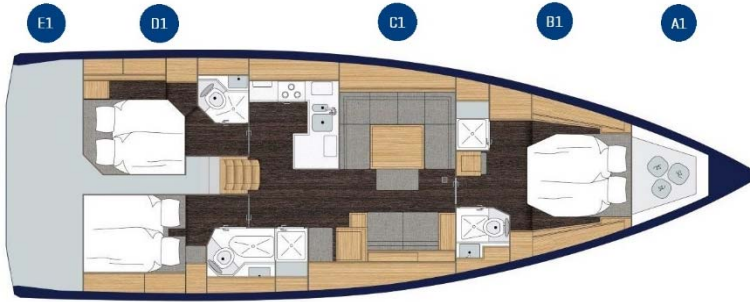

Standard Equipment

Hull

Vacuum infused hull in sandwich construction using polyester resin

Keel

L-shaped keel, cast iron, draft 2,30 m

Steering System

Twin wheel steering system

PROPULSION

Diesel engine, Yanmar 4JH80, 59 kW / 80 hp, sail drive

Interior Layout

A1: Sail locker

C1: Saloon incl. full function L shaped galley, dining area on port, lounge area and chart table on stb

D1: VIP cabin incl. ensuite bathroom on port, guest cabin twin bed incl. ensuite bathroom with separate shower stall on stb

Interior Styling

"Classic" Mahogany interior, floor in "Oceanline" optic Blinds incl. mosquito nets for hatches, saloon and cabins

Upholstery

Upholstery "Vela" in saloon [according to Bavaria Style Guide] Mattress cover in cabins, light grey

Cockpit & Deck

Cockpit floor, side decks and coach roof with non-slip structure

Teak on cockpit benches and bathing platform

Lifting entrance door with lock, acrylic

All hatches flush

Dedicated life raft storage on cockpit floor

Mooring & Anchoring

Stainless steel anchor arm with roller, fixed Electrical windlass

Standing & Running Gear

Rodkicker

Halyards in Dyneema quality

Interior Equipment

Drawer fridge incl. freezer unit on stb, totalling 155 L

LED overhead lights

Plumbing System

40 L water heater

70 L holding tank, per toilet

1 x manual bilge pump

Electrical Systems

1 x engine battery, 12 V / 95 Ah, AGM

2 x service batteries, 12 V / 2 x 95 Ah, AGM

Battery charger, 40 Ah [3 channels]

230 V outlet in each cabin

Country version EU

Trim Level Equipment PRELIMINARY PRICELIST	HOLIDAY	STYLE	AMBITION	C50
Hull				
Hull colour signal white with dark blue cove- and waterline	■			
Hull colour signal white with silk grey cove- and waterline		■		
Hull colour signal white with jet black cove- and waterline			■	
Steering System				
Single rudder	■	■		
Ambition single rudder			■	
Ambition steering pedestals, silk grey			■	
Propulsion				
Engine throttle control, mounted on side of steering pedestal, stb side, mechanical	■	■		
Engine throttle control, mounted on side coaming stb, mechanical			■	
3 blade fixed propeller	■			
3 blade folding propeller		■	■	
Interior Layout				
A1: Sail locker	■	■	■	
B1: Queen size "island" double berth with ensuite bathroom and separate shower stall incl. storage space		■	■	
B2: 2 double cabins incl. storage space, 2 bathrooms and "Flex" bulkhead fwd cabin system	■			
C1: Saloon incl. full function L shaped galley, dining area on port, lounge area and chart table on stb	■	■	■	
D1: 2 twin cabins aft incl. bathroom with separate shower stall on stb	■	■	■	
E1: Storage space for toys and equipment, access from cockpit floor	■		■	
E2: Dinghy garage with integrated wetbar on transom		■		
Interior Styling				
Laminate worktop surface in galley "brown stone"	■		■	
Solid worktop surface in galley "gravel"		■		
Upholstered headboard in front cabin (B1)		■		
Fabric covered headlining panels in saloon		■		
Leather style covered chart table		■		
Leather style covered handrails		■		
Carbon style material covered chart table			■	
Carbon style material covered handrails			■	
Cockpit & Deck				
5 spoke stainless steel steering wheels covered with leather	■	■		
Composite steering wheels Y-spoke, white or black			■	
Single cockpit table incl. storage space, fixed	■			
Twin cockpit tables, fixed		■		
Rope storage boxes, at helm position		■		
Rope storage bags, at helm position			■	
Eyebrows and halyard lids in silk grey			■	
Full size bathing platform, electric	■	■		
Ambition bathing platform, electric			■	
Mooring & Anchoring				
6 mooring cleats, stainless steel, fixed	■			
6 mooring cleats, aluminium, retractable		■	■	
Standing & Running Gear				
Sportmast deck stepped 2 spreader, aluminium	■	■		
Ambition mast deck stepped 2 spreader, aluminium (taller mast with tapered top for increased performance)			■	
Above deck jib furling system	■			
Under deck jib furling system		■	■	
Backstay adjuster, toggle	■			
Backstay adjuster, mechanical		■	■	
Midboom sheeting system with 2 stand up blocks	■	■		
Endboom sheeting system stand up block in cockpit			■	
Elvström Duratech Dacron (HD) mainsail & self-tacking jib	■			
Elvström Cruisetech Dacron mainsail & self-tacking jib		■	■	
Fully battened mainsail with MDS-system, incl. 2 reefs			■	
Winches				
2 x Lewmar 55ST EVO halyard winches, manual	■	■		
2 x Lewmar 55ST EVO genoa/gennaker/code 0 winches, manual		■		
2 x Lewmar 65ST Race EVO halyard winches, manual			■	
2 x Lewmar 65ST Race EVO genoa/gennaker/code 0 winches, manual			■	
Interior Equipment				
2 burner stove with oven	■		■	
3 burner stove with oven		■		
Reading lights incl. USB charger, saloon and cabins		■		
Fixed dining table incl. fixed single leg	■		■	
Foldable dining table incl. fixed single leg		■		
Stainless steel book holders in saloon		■		
Handrail on ceiling covered with leather		■		
Handrail on ceiling covered with carbon style material			■	
Electrical Systems				
9" Digital Switching System incl. multifunction display at chart table with GPS function	■			
12" Digital Switching System incl. multifunction display at chart table with GPS function		■	■	

SAIL READY Packages PRELIMINARY PRICELIST	HOLIDAY	STYLE	AMBITION	Price excl. VAT	C50
SAIL READY PACK "HOLIDAY" (HP)	○	—	—	12.900,00 €	<input type="checkbox"/>
E2: Dinghy garage with integrated wetbar on transom					
Sprayhood with handhold					
Additional 2 x service batteries, 12 V / 2 x 95 Ah, AGM					
Guard rail exit, both sides					
Anchor "Delta" 25 kg, galvanized incl. chain, galvanized, 10 mm, 50 m					
Courtesy lights in saloon					
Curtains for coachroof windows and hull portlights - Pleated					
Mooring kit (8 fenders and 4 mooring lines)					
2 x Lewmar 55ST EVO genoa/gennaker/code 0 winches, manual					
3 burner stove with oven					
Reading lights in saloon and cabins incl. USB charger					
Ventilation fans in saloon and cabins					
Handrail on ceiling					
Rope storage boxes, at helm position					
Dining table transformable into double berth incl. cushion, manual					
Stainless steel bow protection					
SAIL READY PACK "STYLE" (SP)	—	○	—	17.900,00 €	<input type="checkbox"/>
Bowthruster incl. 2 x 95 Ah battery, tunnel					
Sprayhood with handhold					
Teak on cockpit bottom					
Additional 2 x service batteries, 12 V / 2 x 95 Ah, AGM					
Guard rail exit, both sides					
Anchor "Delta" 25 kg, galvanized incl. chain, galvanized, 10 mm, 50 m					
Courtesy lights in saloon and in cockpit					
Curtains for coach roof windows and hull portlights - Plisse					
Mooring kit (8 fenders and 4 mooring lines)					
Ambient lights in saloon and cabins, dimmable					
Extractor hood in galley					
SAIL READY PACK "AMBITION" (AP)	—	—	○	27.900,00 €	<input type="checkbox"/>
Bowthruster incl. 2 x 95 Ah battery, retractable					
Sprayhood with handhold					
Teak on cockpit bottom					
Additional 2 x service batteries, 12 V / 2 x 95 Ah, AGM					
Guard rail exit, both sides					
Anchor "Delta" 25 kg, galvanized incl. chain, galvanized, 10mm, 50m					
Courtesy lights in saloon and in cockpit					
Curtains for coachroof windows and hull portlights - Pleated					
Mooring kit (8 fenders and 4 mooring lines)					
Genoa tracks with cars, adjustable from cockpit					
Elvström Sporttech tri-radial laminate mainsail & self-tacking jib					
Composite bowsprit black					

Entertainment Packages PRELIMINARY PRICELIST	HOLIDAY	STYLE	AMBITION	Price excl. VAT	C50
Entertainment Package	○	○	○	1.750,00 €	<input type="checkbox"/>
Fusion entertainment system with integrated DVD player incl. bluetooth streaming, Multi-Zone technology, at chart table					
2 x Fusion high end speakers in saloon					
2 x Fusion high end speakers in cockpit, watertight					
Fusion MS-NRX 200i wired remote control in cockpit					
Fusion wireless link					
Upgrades Entertainment Package					
Fusion MS-RA 205 unit incl. 2x Fusion high end speakers in owner's cabin (B1 only)	—	○	—	900,00 €	<input type="checkbox"/>
TV preparation in saloon incl. lifting mechanism	○	○	○	1.600,00 €	<input type="checkbox"/>
40" flat TV incl. lifting mechanism, antenna and cabling in saloon	○	○	○	2.800,00 €	<input type="checkbox"/>
22" flat TV incl. bracket and cabling in forward cabin (only for B1 layout)	○	○	—	1.680,00 €	<input type="checkbox"/>

Electronic Packages PRELIMINARY PRICELIST	HOLIDAY	STYLE	AMBITION	Price excl. VAT	C50
Electronic "Basic" Package	○	○	○	7.800,00 €	<input type="checkbox"/>
2 x instrument console incl. stainless steel handrails (one per helm station)					
2 x B&G Triton ² instrument displays (one per helm station)					
B&G Zeus ³ 9" multifunction display (at stb helm station)					
B&G V50 VHF radio with AIS (receiver) at chart table incl. cabling and antenna					
B&G Autopilot					
B&G Autopilot control unit (at stb helm station)					
GoFree wireless link					
B&G WR10 wireless remote control for autopilot					
Electronic "Advanced" Package	○	○	○	12.500,00 €	<input type="checkbox"/>
2 x Instrument console incl. stainless steel handrails (one per helm station)					
2 x B&G Triton ² instrument displays (one per helm station)					
2 x B&G Zeus ³ 9" multifunction display (at each helm station)					
B&G V50 VHF radio with AIS (receiver) at chart table incl. cabling and antenna					
B&G H50 wireless remote handset in cockpit					
B&G Autopilot					
B&G Autopilot control unit (at stb helm station)					
GoFree wireless link					
B&G WR10 wireless remote control for autopilot					

Electronic "Premium" Package	—	○	on request	19.500,00 €	<input type="checkbox"/>
2 x Instrument console incl. stainless steel handrails (one per helm station)					
2 x B&G H5000 graphic displays (one per helm station)					
2 x B&G Zeus ³ 12" multifunction display (at stb helm station)					
B&G V50 VHF radio with AIS [receiver] at chart table incl. cabling and antenna					
B&G H50 wireless remote handset in cockpit					
B&G Autopilot					
2 x B&G H5000 Autopilot control unit (one per helm station)					
B&G H5000 Hydra computer					
NMEA engine information interface for chart plotter					
GoFree track					
B&G WR10 wireless remote control for autopilot					
Upgrades to electronic packages					
B&G 4G radar	○	○	○	2.450,00 €	<input type="checkbox"/>
B&G Forward looking sonar	—	○	○	950,00 €	<input type="checkbox"/>
B&G NAIS 500 AIS Class B transponder	○	○	○	1.100,00 €	<input type="checkbox"/>
GoFree track (included in Electronic „Premium“ Package)	○	○	○	1.200,00 €	<input type="checkbox"/>

Individual Options

	HOLIDAY	STYLE	AMBITION	Price excl. VAT	C50
Hull/Keel					
Hull colour silk grey with white cove- and waterline	—	○	—	5.200,00 €	<input type="checkbox"/>
Cove- and waterline colour silk grey	○	●	—	750,00 €	<input type="checkbox"/>
L-shaped keel, cast iron, shallow draft 1,85 m	○	○	—	2.100,00 €	<input type="checkbox"/>
L-shaped Ambition keel, cast iron/lead, draft 2,70 m	—	○	○	12.800,00 €	<input type="checkbox"/>
Propulsion					
3 blade folding propeller	○	●	●	1.600,00 €	<input type="checkbox"/>
Bow thruster incl. 2 x 95 Ah battery, tunnel	○	—	—	6.900,00 €	<input type="checkbox"/> SP
Bow thruster incl. 2 x 95 Ah battery, retractable	—	○	○	12.800,00 €	<input type="checkbox"/> AP
Bow thruster incl. 2 x 95 Ah battery, retractable as an upgrade to SAIL READY PACK "STYLE"	—	○	—	5.900,00 €	<input type="checkbox"/>
Stern thruster incl. 2 x 95 Ah battery, retractable (only with bow thruster)	○	○	○	12.800,00 €	<input type="checkbox"/>
Interior Layout					
A2: Crew cabin with sink, marine toilet and storage space	○	○	○	3.700,00 €	<input type="checkbox"/>
B2: 2 double cabins incl. storage space, 2 bathrooms and "Flex" bulkhead fwd cabin system	●	○	○	3.700,00 €	<input type="checkbox"/>
D2: 2 twin cabins aft, incl. bunk cabin on stb (only with B2 layout)	○	—	—	2.100,00 €	<input type="checkbox"/>
D3: 2 twin cabins aft incl. head and utility room on stb	—	○	○	1.500,00 €	<input type="checkbox"/>
E2: Dinghy garage with integrated wetbar on transom	○	●	—	2.950,00 €	<input type="checkbox"/> HP
Dining table, lowerable and folding, convertible into double berth incl. cushion insert	—	○	○	2.210,00 €	<input type="checkbox"/>
Interior Styling [according to Bavaria Style Guide]					
"Classic" Mahogany interior incl. Oceanline floorboard	●	●	●	standard	<input type="checkbox"/>
"Club" Oak style interior furniture incl. Wenge floorboards	○	○	○	4.500,00 €	<input type="checkbox"/>
"Elegant" Walnut style interior furniture incl. Elm floorboards	—	○	—	5.000,00 €	<input type="checkbox"/>
Laminate worktop surface in galley "Pure White stone"	○	—	○	250,00 €	<input type="checkbox"/>
Solid worktop surface in galley "Crispy Milk"	—	○	—	520,00 €	<input type="checkbox"/>
Upholstery [according to Bavaria Style Guide]					
Upholstery "Vela" in saloon (Sand standard)	●	●	●	standard	<input type="checkbox"/>
Upholstery "Nautilus" in saloon	—	○	○	1.060,00 €	<input type="checkbox"/>
Upholstery "Opus" in saloon, artificial leather	○	○	○	1.250,00 €	<input type="checkbox"/>
Upholstery "Savoy" in saloon, leather	—	○	○	4.950,00 €	<input type="checkbox"/>
Luxury cold foam mattress with memory top incl. box springs for all berths	○	○	○	3.500,00 €	<input type="checkbox"/>
Carpet in saloon, wool	—	○	—	1.750,00 €	<input type="checkbox"/>
Carpet in cabins, wool	—	○	—	1.250,00 €	<input type="checkbox"/>
Carpet in saloon, vinyl	○	—	—	1.250,00 €	<input type="checkbox"/>
Cockpit Upholstery [according to Bavaria Style Guide]					
Comfort cockpit cushions incl. backrests and 6 scattered cushions	—	○	—	2.950,00 €	<input type="checkbox"/>
Cockpit cushions inserts for lowerable tables	—	○	—	500,00 €	<input type="checkbox"/>
Cockpit cushions for benches	○	○	○	1.750,00 €	<input type="checkbox"/>
Sun bed cushions on coachroof incl. headrest and cup holders	○	○	○	1.450,00 €	<input type="checkbox"/>
Sun bed cushions on foredeck incl. headrest and cup holders	○	○	—	1.550,00 €	<input type="checkbox"/>
Deck Flooring					
Teak on cockpit bottom	○	○	○	2.900,00 €	<input type="checkbox"/> SP, AP
Teak on side decks	○	○	○	17.900,00 €	<input type="checkbox"/>
Teak on coachroof	—	○	—	4.200,00 €	<input type="checkbox"/>
Esthec composite decking material on cockpit benches and bathing platform instead of teak	○	○	○	500,00 €	<input type="checkbox"/>
Esthec composite decking material on cockpit bottom	○	○	○	3.500,00 €	<input type="checkbox"/>
Esthec composite decking material on cockpit bottom instead of teak as an upgrade to SAIL READY PACKS "STYLE" and "AMBITION"	○	○	○	500,00 €	<input type="checkbox"/>
Esthec composite decking material on side decks	○	○	○	19.900,00 €	<input type="checkbox"/>
Esthec composite decking material on coachroof	—	○	—	5.100,00 €	<input type="checkbox"/>
Cockpit & Deck					
Composite steering wheels Y-spoke, white or black	○	○	●	1.450,00 €	<input type="checkbox"/>
2 lowerable cockpit tables convertible in sun bathing area, electric	—	○	—	on request	
Removable single cockpit table	—	—	○	1.500,00 €	<input type="checkbox"/>
Drawer fridge incl. compressor at wet bar, 20 L (only in combination with E2)	○	○	—	1.050,00 €	<input type="checkbox"/>
BBQ in wet bar, gas (only in combination with E2)	○	○	—	1.500,00 €	<input type="checkbox"/>
Guard rail exit, both sides	○	○	○	770,00 €	<input type="checkbox"/> HP, SP, AP
Guard rail exit ladder, stainless steel	○	○	○	680,00 €	<input type="checkbox"/>
Pulpit seats, teak	○	○	—	850,00 €	<input type="checkbox"/>
Hoods [according to Bavaria Style guide]					
Bimini top	○	○	○	4.650,00 €	<input type="checkbox"/>
Bimini top incl. LED overhead lighting	○	○	○	4.950,00 €	<input type="checkbox"/>

Tender & Toys					
Manual telescopic davits, retractable	—	○	—	2.650,00 €	<input type="checkbox"/>
12 V air compressor at transom for tender or toys	○	○	—	680,00 €	<input type="checkbox"/>
Mooring & Anchoring					
Stainless steel bow protection	○	○	—	450,00 €	<input type="checkbox"/> HP
Anchor "Delta" 25 kg and chain 10 mm, 50 m, stainless steel instead of galvanized	○	○	○	2.500,00 €	<input type="checkbox"/>
Anchor windlass with capstans, electrical, upgrade	○	○	—	990,00 €	<input type="checkbox"/>
Teak rubrail incl. stainless steel rail	○	○	○	4.350,00 €	<input type="checkbox"/>
Standing & Running Gear					
Carbon performance mast, boom and spreaders incl. rod rigging	—	○	○	on request	<input type="checkbox"/>
Composite "V-Boom" incl. sailcover instead of standard boom	—	○	○	on request	
Mainsail furling system incl. upgrade to furling mainsail (not available for EPEX sails and carbon rigs)	○	○	—	4.300,00 €	<input type="checkbox"/>
Elvström mainsail & self-tacking jib - Sporttech triradial laminate instead of standard	○	○	○	6.600,00 €	<input type="checkbox"/> AP
Elvström mainsail & self-tacking jib - EPEX high performance membrane	—	○	○	20.500,00 €	<input type="checkbox"/>
Elvström mainsail & self-tacking jib - EPEX high performance membrane (upgrade to SAIL READY PACK "AMBITION")	—	—	○	13.900,00 €	<input type="checkbox"/>
Elvström genoa 106% - Duratech Dacron (HD) (only with genoa tracks)	○	—	—	4.380,00 €	<input type="checkbox"/>
Elvström genoa 106% - Cruisetech Dacron (only with genoa tracks)	—	○	○	3.980,00 €	<input type="checkbox"/>
Elvström genoa 106% - Sporttech triradial laminate (only with genoa tracks)	—	○	○	6.880,00 €	<input type="checkbox"/>
Elvström genoa 106% - EPEX high performance membrane (only with genoa tracks)	—	○	○	10.500,00 €	<input type="checkbox"/>
Genoa tracks with pin stop cars	○	○	—	1.400,00 €	<input type="checkbox"/>
Compensation for non-delivery of self-tacking jib sail	○	○	○	-1.650,00€	<input type="checkbox"/>
Backstay adjuster, mechanical	○	●	●	600,00 €	<input type="checkbox"/>
Spreader lights, 4 pcs.	—	○	○	1.400,00 €	<input type="checkbox"/>
Fully battened mainsail with MDS-system, incl. 2 reefs, offshore-quality (replacing standard mainsail)	○	○	●	1.100,00 €	<input type="checkbox"/>
Elvström gennaker incl. Selden top down furler and gennaker gear (halyard, sheets, blocks, halyard clutch and pad eye for gennaker tack)	—	○	○	8.500,00 €	<input type="checkbox"/>
Elvström gennaker incl. snuffer and gennaker gear (halyard, sheets, blocks, halyard clutch and pad eye)	○	○	○	7.200,00 €	<input type="checkbox"/>
Elvström code 0 incl. Selden CX furler and gear (halyard, sheets, blocks, halyard clutch and pad eye for code 0 tack)	—	○	○	9.500,00 €	<input type="checkbox"/>
Lazy bag with lazy jacks (according to Bavaria Style guide)	○	○	○	1.300,00 €	<input type="checkbox"/>
Composite bowsprit (white for „Style“ / black for „Ambition“)	—	○	○	2.980,00 €	<input type="checkbox"/> AP
Winches					
2 x Lewmar 55ST EVO genoa/gennaker/code 0 winches, manual	○	●	—	1.400,00 €	<input type="checkbox"/> HP
2 x Lewmar 55EST EVO halyard winches, electrical	○	○	—	4.900,00 €	<input type="checkbox"/>
2 x Lewmar 55EST EVO genoa/gennaker/code 0 winches, electrical	—	○	—	4.900,00 €	<input type="checkbox"/>
2 x Lewmar 65ST Race EVO halyard winches, electric	—	—	○	6.900,00 €	<input type="checkbox"/>
2 x Lewmar 65ST Race EVO genoa/gennaker/code 0 winches, electric	—	—	○	6.900,00 €	<input type="checkbox"/>
Additional 2 x Lewmar 65ST Race EVO mainsheet winches on cockpit coaming, manual	—	—	○	4.900,00 €	<input type="checkbox"/>
Interior Equipment - Water					
Washing machine, 220 V (incl. grey water tank, only with D3 layout)	—	○	—	1.980,00 €	<input type="checkbox"/>
Electric toilet (1x) front cabin with fresh water flush system for B1 layout	○	○	○	1.050,00 €	<input type="checkbox"/>
Electric toilet (2x) front cabin with fresh water flush system for B2 layout	○	○	○	2.100,00 €	<input type="checkbox"/>
Electric toilet (2x) aft cabin with fresh water flush system for D1 or D3 layout	○	○	○	2.100,00 €	<input type="checkbox"/>
Electric toilet (1x) aft cabin with fresh water flush system for D2 layout	○	○	○	1.050,00 €	<input type="checkbox"/>
Grey water system, totalling 200 L	○	○	○	3.500,00 €	<input type="checkbox"/>
Interior Equipment - Galley					
Microwave, 220 V	○	○	○	560,00 €	<input type="checkbox"/>
Dishwasher, drawer 220 V (incl. grey water tank)	○	○	○	2.200,00 €	<input type="checkbox"/>
Additional fridge in galley, 110 L, top loading	○	○	○	1.100,00 €	<input type="checkbox"/>
Extractor hood in galley	—	○	○	750,00 €	<input type="checkbox"/>
Interior Equipment - Fresh Air					
Air conditioning "Basic" 24.000 BTU, saloon and cabins incl. 2 nd shore power (220 V / 110 V, only with generator)	○	○	on request	12.500,00 €	<input type="checkbox"/>
Air conditioning "Adria" 32.000 BTU, saloon and cabins incl. 2 nd shore power (220 V / 110 V, only with generator)	○	○	on request	16.200,00 €	<input type="checkbox"/>
Air conditioning "Gulf" 40.000 BTU, saloon and cabins incl. 2 nd shore power (220 V / 110 V, only with generator)	—	○	—	19.900,00 €	<input type="checkbox"/>
Interior Equipment - Heating					
Hot air heating, 5,5 kW, outlets in saloon and cabins, fueling via diesel tank	○	○	○	6.350,00 €	<input type="checkbox"/>
Ventilation fans in saloon and cabins	○	○	—	1.250,00 €	<input type="checkbox"/> HP
Electrical Systems 230V					
Inverter 2000 W [true sine wave] for 230 V Shore power	○	○	○	2.200,00 €	<input type="checkbox"/>
Inverter 2000 W [true sine wave] for 110 V Shore power	○	○	○	2.500,00 €	<input type="checkbox"/>
Generator 6.4 kW / 8kVA, 50 Hz, 230 V	○	○	—	16.500,00 €	<input type="checkbox"/>
Generator 6.4 kW / 8kVA, 60 Hz, 110 V	○	○	—	19.500,00 €	<input type="checkbox"/>
Country version US/JPN	○	○	○	3.000,00 €	<input type="checkbox"/>
Miscellaneous					
Underwater lights, 4 pcs.	—	○	○	1.760,00 €	<input type="checkbox"/>
Composite gangway incl. bag and stanchions, foldable, 230 cm	○	○	○	2.200,00 €	<input type="checkbox"/>
Electronic safe (only with B1 layout)	—	○	—	660,00 €	<input type="checkbox"/>
Fresh water dockside inlet	○	○	—	500,00 €	<input type="checkbox"/>
Cockpit tables cover	—	○	—	580,00 €	<input type="checkbox"/>
Steering wheels covers	—	○	—	380,00 €	<input type="checkbox"/>
Shipment					
Steel cradle for overseas transport	○	○	○	3.200,00 €	<input type="checkbox"/>
Shrink wrap	○	○	○	900,00 €	<input type="checkbox"/>

Bavaria Yachtbau GmbH, Bavariastraße 1, 97232 Giebelstadt, Germany, Phone +49 9334 942-0, Fax +49 9334 942-116, www.bavariayachts.com, info@bavariayachts.com

All prices are in EURO and are valid only in conjunction and at the time of ordering a new yacht ex works Giebelstadt. All weights and measurements are calculations based upon construction documents. Options may replace standard equipment. The brochure is intended for advertisement only and is not part of a contract, warranty or of an offer. We reserve the right to modify or improve our products and to change specifications without notice. We are not liable for errors and printing mistakes. The expense of rigging out and launching is to be invoiced individually and separately. All rights are reserved to execute alterations in construction and equipment without notice. Aforementioned prices are recommended sales prices for deliveries ex works within 4 months of order placement. Later deliveries are subject to invoicing according to the then valid price list.

Version: 1/2018

Valid from 2017

Publication: 22nd November 2017 – Non binding preliminary pricelist

Language/Taxes: English pricelist/all prices excl. VAT

